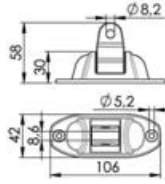

OSCULATI**180° articulated joint for bimini tops****AISI 316**

Made of mirror-polished AISI 316 stainless steel, high-resistance version for large bimini tops with 25/30-mm tube frame

Code	Base mm	Pin mm
46.667.00	106x42	8

Swivelling 180° hood junction**AISI 316**

Made of AISI 316 stainless steel, includes plastic base.

Code	Length mm	With screw mm
46.665.00	70	6



37.264.10 Pin INCLUDED

Awning base**OSCULATI****AISI 316**

Made of AISI 316 stainless steel, fitted with retrievable fork pin.

Code	Base mm	For tubes Ø mm	Pin mm
46.670.00	90x40	22/25	6

OSCULATI**Snap base for biminis or awnings****AISI 316**

Snap hooking system.

Code	Description	For tube Ø mm	Pin mm
46.670.10	90x40-mm external base	22/25	6
46.670.20	54x29-mm recess fit base	22/25	6

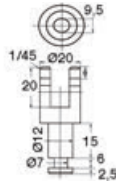
**Fork****AISI 316**

Made of polished AISI 316 stainless steel, suitable for awning gunwale-mounting on dinghies.

Code	Pivot Ø mm
46.662.00	12x23

**Hood sleeve coupling****AISI 316**

Made of mirror-polished AISI 316 stainless steel.

For tubes Ø mm	With lock pin	With spring lock	Length mm	Screw / pin mm
22	46.978.00	46.978.01	73.5	6
25	46.978.10	46.978.11	75.7	6
30	46.978.20	46.978.21	85	6

**Bimini sliding bracket****AISI 316**

Made of mirror polished AISI 316 stainless steel, fitted with cam quick clamping system.

Code	For tubes Ø mm	Pin mm
46.978.50	22	6
46.978.51	25	6

**Sliding awning clamps**

Enables for the hood to slide back and forth, made of chromed brass and fitted with stainless steel screws.

Code	Mounting on tube Ø mm	Pin mm
46.185.22	20/22/25	5