



### Motor Flusher "C"

52.749.03 Designed for washing outboard engines Mercury/Mariner 4/5HP, made of **turned brass**.

**OSCULATI**



### Motor flusher D

Washing system for outboard engines equipped with threaded connector. The system consists in a special threaded valve + snap fitting 36.189.02 The valve can be permanently installed on the outboard engine.

Code	Description
52.749.10	Kit for Johnson / Evinrude
52.749.11	Kit for Mercury / Yamaha and all others



## Accessories and spare parts for outboard

**OSCULATI**



### Manual siphon pump

This siphon pump easily transfers any liquid (water, diesel, petrol, etc.) from a container to another preventing dirt and fatigue.

Place the pump into the container with the liquid and the end of its hose into the transfer container; take care to place the second container at a slightly lower level.

Stir the pump in the liquid to let it rise up to the hose gooseneck and make it fall into the other container. Disconnect the pump from the hose to stop the flow.

Made of copper and supplied with 1.7-m hose. No electricity required, fast, safe and clean.

Code	Net passage mm	Hose Ø mm	Flow l/min
52.739.00	14	15	10
52.739.01	18	19	15

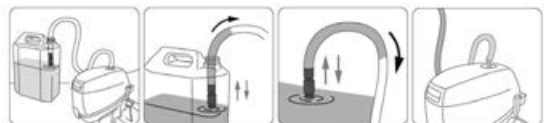

### Blue Bag thermo-welded water-proof engine cover

Preserve **outboard or inboard engine** from creation of sea vegetation (slime, barnacles and other species). It can also be used to **wash the cooling system with fresh water**, without hauling the boat.

Easy to install and dismount.

Made of tough fabric with double PVC coating to be very durable.

Code	For engines
52.757.01	Up to 80 HP outboard
52.757.02	Over 80 HP outboard + sterndrive units
52.757.03	Over 250 HP outboard + sterndrive units

### EasyTroller Trolling plate

Exclusive made-in-USA system that slows boats to ideal trolling speed, even as slow as 1 knot. The patented spring hinge design flexes upward to prevent damage to the trolling plate under accidental acceleration. It mounts directly to the cavitation plate of your outboard or outdrive.

When lifted during planing, it snaps into position by simply pulling its cable.

Code	Material	Plate width cm	For engines HP
52.280.00	Marine anodized aluminium and SS	36.38	50/300

