

**Extra-flat dual cone loudspeakers**

**WATERPROOF**    **UV RESISTANT**

ABS case, polypropylene cone. Ultra-flat version for **minimum recess**.

Code	Colour	Type	Power W		Response frequency Hz	Sensitivity dB	Compass min. distance m	mm			
			RMS	Max				D	d	H	h
29.742.01	White	4"	10x2	20x2	90-18000	90	0.80	133	95	38	23
29.742.02	Black	4"	10x2	20x2	90-18000	90	0.80	133	95	38	23
29.742.03	White	5.25"	20x2	40x2	80-18000	90	0.80	162.5	119	39.5	23
29.742.04	Black	5.25"	20x2	40x2	80-18000	90	0.80	162.5	119	39.5	23
29.742.05	White	6.5"	30x2	60x2	60-18000	91	1.00	186	135	40	23.5
29.742.06	Black	6.5"	30x2	60x2	60-18000	91	1.00	186	135	40	23.5



▲ 29.742.02/04/06



▲ 29.742.01/03/05

**2-way speakers**

**WATERPROOF** 2-way speakers (for an improved acoustic performance) with separate tweeter. Designed for indoor and outdoor use. Min. distance from the compass: 1.1 m.

Code	Color	Ø A mm	Ø B mm	D mm	Power W		Frequency HZ	Ohm	Magnetis m
					RMS	Peak			
29.740.01	White	160	125	57	20+20	30+30	80-20000	4.0	y25
29.740.02	White	188	144	57	25+25	40+40	95-25000	4.0	y25

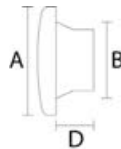

**OSCULATI**



**2-way loud speakers, Slim version, 23-mm depth**

**WATERPROOF** Two-way system (for better performance to lows and highs) with separate tweeter. For indoor and outdoor use. Min. distance from the compass: 1 m.

Code	Colour	Ø A mm	Ø B mm	C mm	Power W (pair)		Frequency Hz
					Rms	Max	
29.721.99	White	150	120	23 *	40	60	60 - 18000
29.721.98	Black	150	120	23 *	40	60	60 - 18000

\* Designed for installation with little recess depth

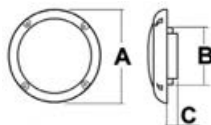

**OSCULATI**



▲ 29.721.99

▲ 29.721.98

**RIVIERA loud speakers**

**NON MAGNETIC / AMAGNETICHE**    **WATERPROOF**

UV-resistant, with ferrite magnet.

Code	Color	Type	watt	Db	RsHz	Ohm
29.168.00	White	Double-cone	80	90	55-16000	4
29.168.20	White	Two-way	120	90	50-20000	4

