

Cam expansion drain plugs

Suitable for draining water from the cockpit, fish baskets, fish bait cases; rotating adjustable pressure; brass cam, stainless steel washers, neoprene body.

Code	For holes mm
18.532.00	9/10
18.532.01	12/13
18.532.04	13.5/14.5
18.532.03	15/16
18.532.05	17/18
18.532.02	18.5/19.5



Water drain plugs

Fitted with bushing. press to install.

Code	Material	Color	Ø mm
18.536.00	nylon	black	20
18.636.00	nylon	white	20



Water drain bushing to couple with expansion plugs

Made of nylon.

Colour		←→ mm	Bore Ø mm
white	black		
18.836.01	18.736.01	150	22.7
18.836.02	18.736.02	150 (30 with 19-mm Ø hose adaptor)	22.7
18.836.00	18.736.00	78	22.7



Bushing for expansion plugs

Made of chromed brass with hose adaptor.

Code	←→ mm			Bore Ø mm
	D	L	G	
18.531.35	65	80	1"1/4	35
18.531.42	65	82	1"1/2	42
18.531.50	80	99	2"	50

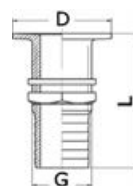

Neoprene self-draining NAUTISPEED plug



Suitable for transoms, it automatically opens and drains the boat hull once a preset speed is reached.

Code	Minimum speed
18.343.00	30 km/h

Water drain plug

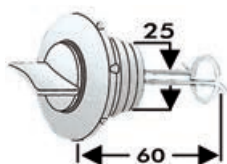

Made of nylon, fitted with plug safety system, press to mount by means of the bushing included, Ø to be bored on the boat: 25mm. Colour: white.

Code	ORDER BY BOX
18.346.10	10

Drain plug fitted with valve for rubber dinghies



Nylon bushing, rubber valve and plug.

Code	Ø mm
18.534.00	36

Cam driven expansion floating drain plug

Suitable to drain water from cockpits, fish baskets, fish bait cases. Rotating adjustable pressure. Neoprene body and nylon frame. **3-pcs kit.**

Code	Ø mm
18.532.10	12 (1/2") + 16 (5/8") + 19 (3/4")



Drain plug

Made of **chromed brass**, fitted with nylon plug and special locking plug device, remains attached even after been unscrewed.

Code	Outside mm	Recess bore Ø mm	Centre distance bore mm	Water passage bore Ø mm
18.538.00	52.5x35.5	25	38	17.5
18.538.01	59.5x40	35	45.5	25

